



ARIZONA DEPARTMENT OF
EDUCATION

Special Education Data Updates

ESS Data Management
March 2026

Enabling Live Captions

To use live captions in Teams, go to the meeting controls at the top of the screen and select More > Settings > Accessibility

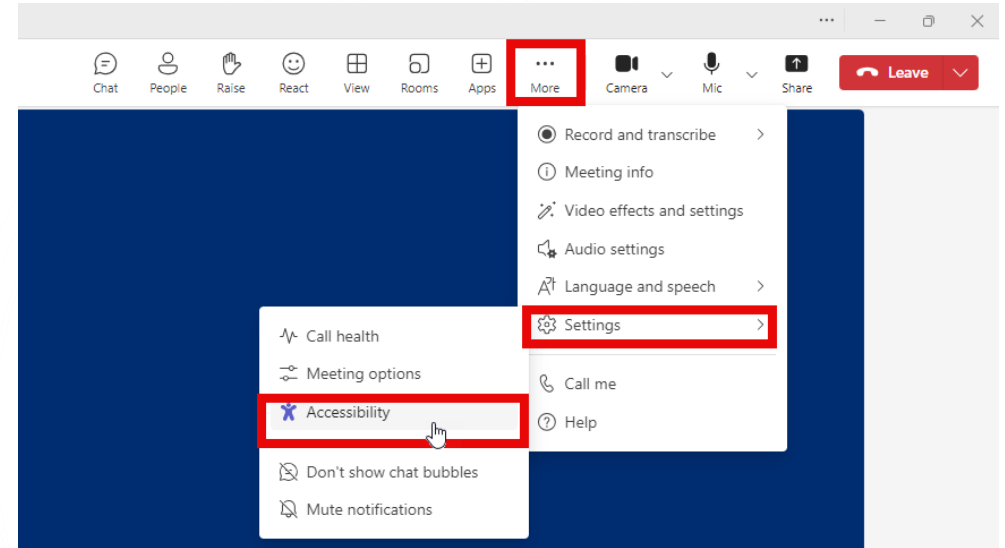

- Please stay muted throughout the presentation
- There will be a Q&A session at the end
- We will post this webinar recording on the [ESS Data Management webpage](#)

The use of AI meeting assistants, such as Otter.ai and Chorus.ai, that record audio of the meeting, write notes, capture action items, and generate meeting summaries for virtual meetings is prohibited.

Interpreters, If Available

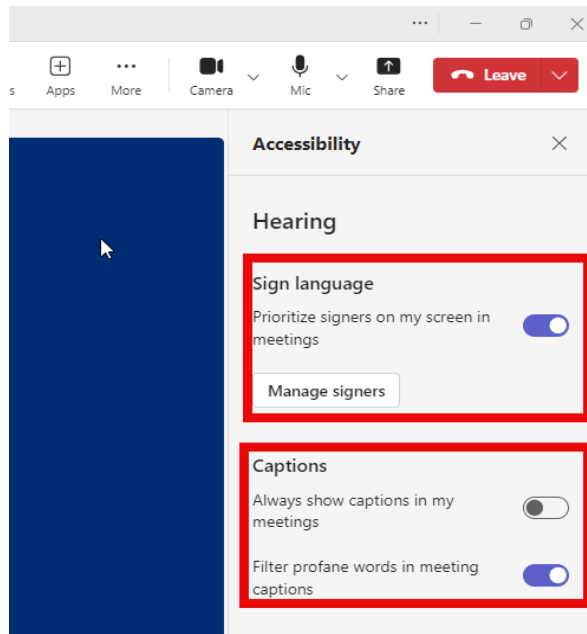

In the Accessibility options, you can manage how you view the signers (interpreters), if applicable, and turn on captions

- Please stay muted throughout the presentation
- There will be a Q&A session at the end
- We will post this webinar recording on the [ESS Data Management webpage](#)

The use of AI meeting assistants, such as Otter.ai and Chorus.ai, that record audio of the meeting, write notes, capture action items, and generate meeting summaries for virtual meetings is prohibited.

Agenda

- Reminders
- Q&A

Special Education Data Updates

Reminders



What You Need to Know

- Recording: February SEDU
- Statement of Assurances
 - Opens April 1, 2026
- Parent Involvement Survey
 - Due May 31, 2026
 - [Parent Survey Inbox](#)

New Integrity Error -40103

- Error Message
 - All students with special education services must have a Resident School Id for each day of the LRE.
- Reasoning
 - Inaccurate data is due to misreporting of Resident School ID and dates.
- Troubleshooting
 - Resident School ID dates are available for review in the SPED10 report. Verify dates align with reported services.

Special Education Data Updates

Q&A



General Guidelines

- General Questions
- Troubleshooting with AzEDS
- NO Personally Identifiable Information (PII)
 - SSID investigation assistance?
 - Email the [Data Management Inbox](#)

ADEConnect Support

(602) 542-7378

ESS Data Management Inbox

(602) 542-3962

Subscribe to stay informed:

Data Management Alerts

Data Management Vimeo Channel

Next SEDU Webinar: April 15, 2026

Thank You!

